

# Alfa Laval GJ 9

## Rotary jet heads

---

### Introduction

The Alfa Laval GJ 9 is a rotary jet head tank cleaning machine for use as a portable tank cleaning machine in both industrial and hygienic applications. Built to clean intermediate bulk containers (IBCs) and tanks from 1-6 metre in diameter and up to 6 metre tall, it combines pressure and flow to create high-impact cleaning jets that rotate in a repeatable and reliable 360° cleaning pattern.

The GJ 9 minimizes the consumption of water and cleaning media. The gear train, which uses food-grade lubricants, reduces the risk of particle damage to the machine during operation. Easy to customize to meet customer requirements, it allows companies to spend less time cleaning and more time producing.

### Applications

The Alfa Laval GJ 9 is designed for the removal of the toughest residues from industrial and hygienic IBCs, such as those containing paint, oil, food products, and home care products.

### Benefits

- Cleans IBCs quickly and efficiently
- High-impact cleaning in a 360° repeatable cleaning pattern
- Cleaning process can be validated using Alfa Laval Rotacheck
- Slim design makes it possible to insert through IBC covers
- Lightweight and easy to handle

### Standard design

The choice of nozzle diameters can optimize jet impact length and flow rate at the desired pressure.



## Working principle

The high-impact jet stream from the rotary jet head covers the entire surface 360° of the tank interior in a successively denser pattern. This achieves a powerful mechanical impact with a low volume of water and cleaning media.

The flow of the cleaning fluid makes the nozzles perform a geared rotation around the vertical and horizontal axes. In the first cycle, the nozzles lay out a course pattern on the tank surface. The subsequent cycles gradually make the pattern denser until at full cleaning pattern is reached.

Once the full cleaning pattern is reached, the machine will start over again and continue to perform the next full cleaning pattern.

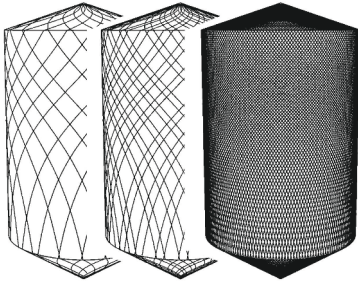

## TECHNICAL DATA

Lubricant:	Food grade
Max. throw length:	1.2 - 6 m

### Pressure

Working pressure:	3 - 70 bar
Recommended pressure:	7 - 41 bar

## PHYSICAL DATA

### Temperature

Max. working temperature:	95 °C
Max. ambient temperature:	140 °C

### Weight

Weight:	2.2 kg
---------	--------

### Connections

Standard thread:	¾" Rp NPT, female/ 1 ¼" camlock
Available option:	¾" BSP, female/ 1 ¼" camlock, 1 ½" tube weld on

## Caution

Avoid hydraulic shock, hard and abrasive particles in the cleaning liquid, as this can cause increased wear and/or damage of internal mechanisms. In general, a filter in the supply line is recommended. Do not use for gas evacuation or air dispersion. For steaming we refer to the manual.

### Pressure - Flow Rate, 2-Nozzle

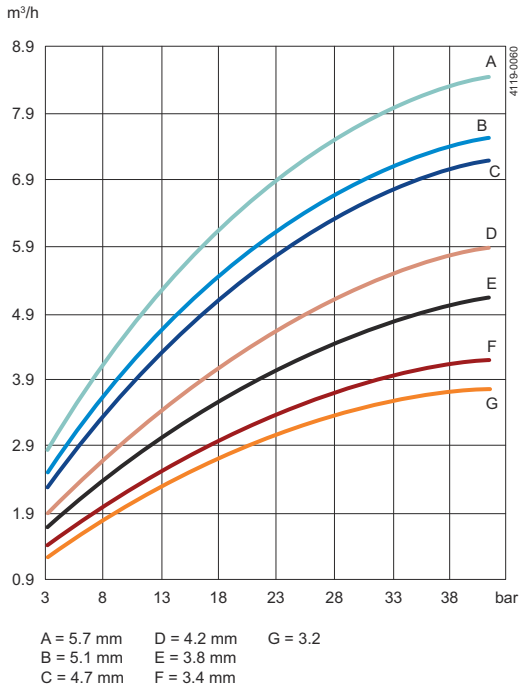

### Flow Rate-Cycle Time

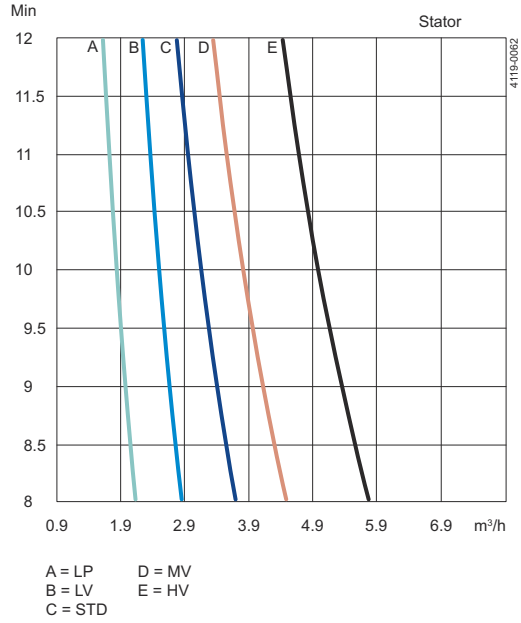

### Pressure - Flow Rate, 4-Nozzle

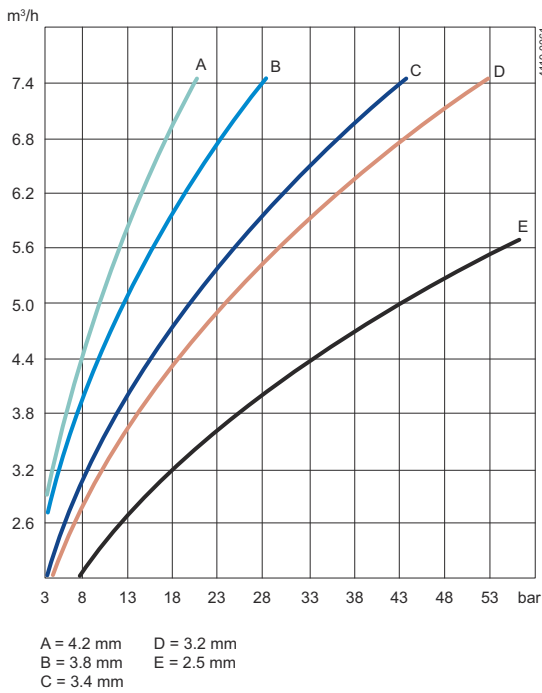

### Throw Distance by Pressure, 2-Nozzle

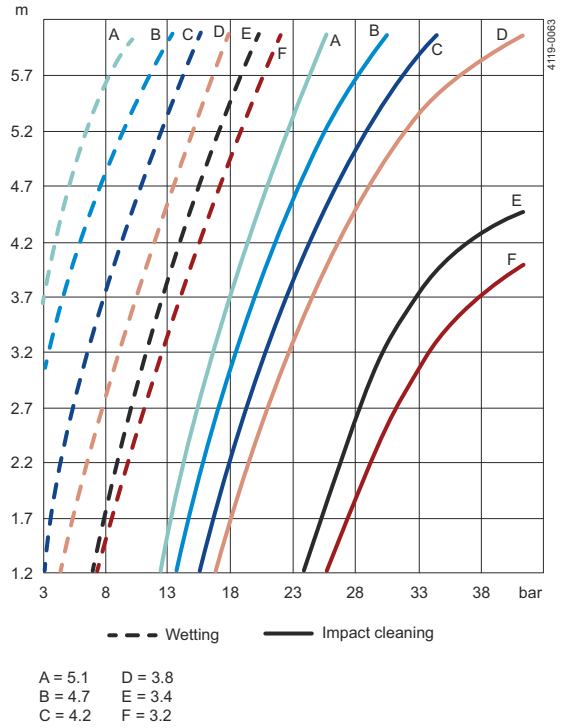

## Throw Distance by Pressure, 4-Nozzle

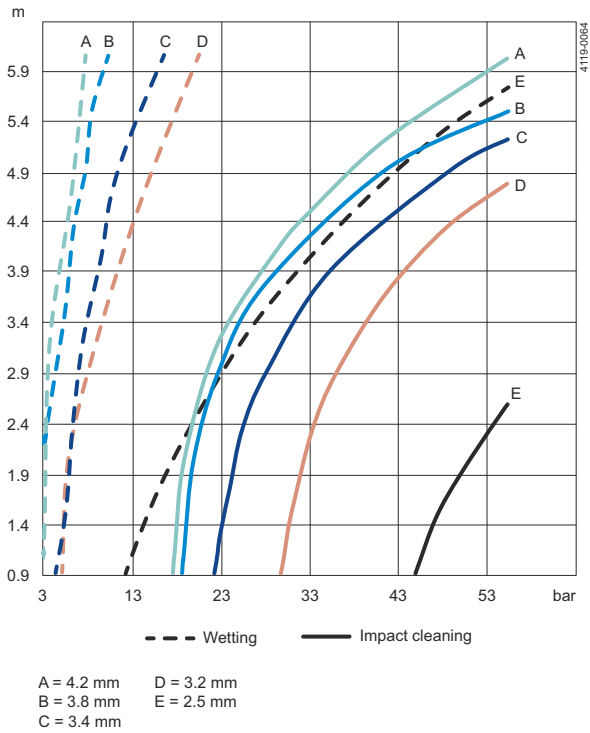

## Dimensions (mm)

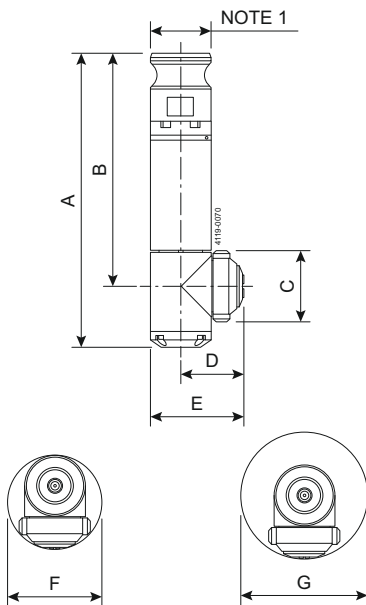

A	B	C	D	E	F	G
223	177	54	48	71	72	96



NOTE 1: 3/4" FNPT/1-1/4" CAMLOCK OR 1-1/2" Tri-Clamp

This document and its contents are subject to copyrights and other intellectual property rights owned by Alfa Laval AB (publ) or any of its affiliates (jointly "Alfa Laval"). No part of this document may be copied, re-produced or transmitted in any form or by any means, or for any purpose, without Alfa Laval's prior express written permission. Information and services provided in this document are made as a benefit and service to the user, and no representations or warranties are made about the accuracy or suitability of this information and these services for any purpose. All rights are reserved.

### How to contact Alfa Laval

Up-to-date Alfa Laval contact details for all countries are always available on our website at [www.alfalaval.com](http://www.alfalaval.com)